

PROJECT ID: 7820-03-72
 COUNTY: EAU CLAIRE

ORDER OF SHEETS

Section No.	1	Title
Section No.	2	Typical Sections and Details
Section No.	3	Estimate of Quantities
Section No.	3	Miscellaneous Quantities
Section No.	4	Right of Way Plat
Section No.	5	Plan and Profile
Section No.	6	Standard Detail Drawings
Section No.	7	Sign Platos
Section No.	8	Structure Plans
Section No.	9	Computer Earthwork Data
Section No.	9	Cross Sections

TOTAL SHEETS =



DESIGN DESIGNATION

A.A.D.T. (2026)	=	1,525
A.A.D.T. (2046)	=	2,690
D.H.V.	=	350
D.D.	=	50/50
T.	=	8%
DESIGN SPEED	=	40 MPH
ESALS	=	XX,XXX

CONVENTIONAL SYMBOLS

PLAN	PROFILE
CORPORATE LIMITS	GRADE LINE
PROPERTY LINE	ORIGINAL GROUND
LOT LINE	MARSH OR ROCK PROFILE (To be noted as such)
LIMITED HIGHWAY EASEMENT	SPECIAL DITCH
EXISTING RIGHT OF WAY	GRADE ELEVATION
PROPOSED OR NEW R/W LINE	CULVERT (Profile View)
SLOPE INTERCEPT	UTILITIES
REFERENCE LINE	ELECTRIC
EXISTING CULVERT	FIBER OPTIC
PROPOSED CULVERT (Box or Pipe)	GAS
COMBUSTIBLE FLUIDS	SANITARY SEWER
	STORM SEWER
	TELEPHONE
MARSH AREA	WATER
	UTILITY PEDESTAL
	POWER POLE
WOODED OR SHRUB AREA	TELEPHONE POLE

STATE OF WISCONSIN
 DEPARTMENT OF TRANSPORTATION

PLAN OF PROPOSED IMPROVEMENT

FALL CREEK - WILSON

EAU CLAIRE RIVER BRIDGE B-18-0249

CTH D
 EAU CLAIRE COUNTY

STATE PROJECT NUMBER
 7820-03-72

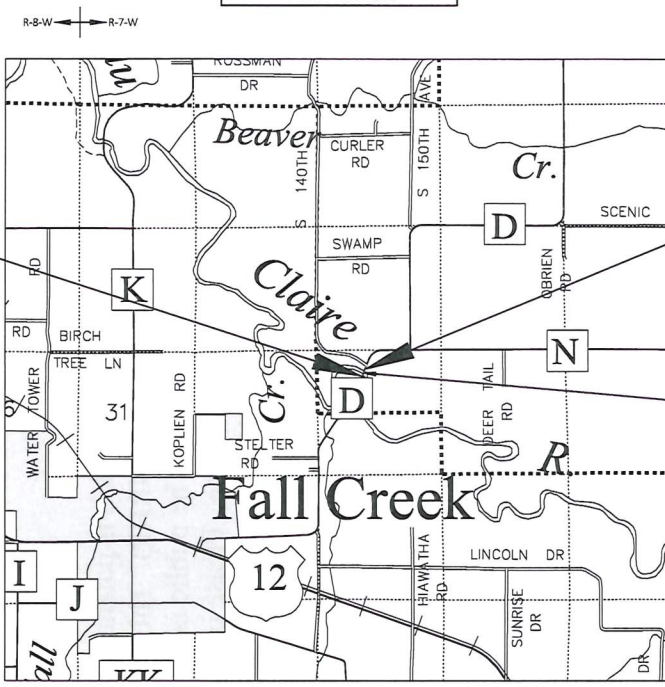

BEGIN PROJECT
 STA 5+50
 Y = 267870.38
 X = 406718.48

END PROJECT
 STA 14+25
 Y = 268686.01
 X = 407035.26

STRUCTURE B-18-0249
 STA XX+XX



TOTAL NET LENGTH OF CENTERLINE = 0.166

HORIZONTAL POSITIONS SHOWN ON THIS PLAN ARE WISCONSIN COORDINATE REFERENCE SYSTEM (WISCRS), EAU CLAIRE COUNTY, NAD83 (2011), IN U.S. SURVEY FEET. POSITIONS SHOWN ARE GRID COORDINATES, GRID BEARINGS, AND GRID DISTANCES. GRID DISTANCES ARE THE SAME AS GROUND DISTANCES.

ELEVATIONS ARE REFERENCED TO NAVD 88 (2018). GPS DERIVED ELEVATIONS ARE BASED ON GEOID 18.

STATE PROJECT	FEDERAL PROJECT	
	PROJECT	CONTRACT
7820-03-72		

ACCEPTED FOR
 COUNTY of EAU CLAIRE
 (Date) (Highway Commissioner)

ORIGINAL PLANS PREPARED BY
AYRES

(Date) (Signature)

STATE OF WISCONSIN
 DEPARTMENT OF TRANSPORTATION

PREPARED BY
 Surveyor AYRES ASSOCIATES INC.
 Designer AYRES ASSOCIATES INC.
 Project Manager TOLU YANG, PE
 Regional Examiner TOLU YANG, PE
 Regional Supervisor TOLU YANG, PE

APPROVED FOR THE DEPARTMENT
 DATE: (Signature)

E