

AGENDA

**County Of Eau Claire
Committee On Parks & Forest
Tuesday, March 22, 2016 – 5:00 p.m.
Ag & Resource Center
227 1st Street W, Altoona WI 54720**

Members note: Please call the committee chair or office if you will not be attending the meeting.

1. Confirmation of meeting notice
2. Approval of minutes from March 8, 2016 meeting – Discussion/action
3. Public Input
4. Fitz/West Wisconsin Land Trust Property in the Town of Brunswick Plan Recommendation from Working Committee – Discussion/action
5. UW-EC Warrior Duathlon Event at Lowes Creek – Discussion/action
6. Handicap ramp at Bedpost Park – Discussion/action
7. Presentation of Spring 2016 Timber Sales – Discussion/action
8. Pinter Pines/Coon Gut Property Future Plan – Discussion/action
9. County Forest Camping Policy – Discussion/action
10. Lake Altoona Dam Repair Phase 2 Update – Discussion/action
11. Correspondence
12. Staff and committee reports
13. Advisory Committee Input/Assignments
14. Exposition Center Advisory Committee Input/Assignments
15. Committee Education
16. Future and pending items: Next meeting date: April 12, 2016, 5 pm at Ag Center

PLEASE NOTE: Upon reasonable notice, efforts will be made to accommodate the needs of individuals with disabilities through sign language, interpreters or other auxiliary aids. For additional information or to request the service, contact the County ADA Coordinator at 839-4710, (FAX) 839-1669 or 839-4735, tty: use Relay (711) or by writing to the ADA Coordinator, Human Resources, Eau Claire County Courthouse, 721 Oxford Avenue, Eau Claire, WI 54703.

**EAU CLAIRE COUNTY
COMMITTEE ON PARKS AND FOREST**

MEETING MINUTES

Tuesday, March 8, 2016, 5:00 p.m.
Agriculture & Resource Center (2nd Floor meeting room)

MEMBERS PRESENT: Gary Gibson, Patrick LaVelle, Paul Lokken, and Bruce Willett

MEMBERS ABSENT: Kevin Stelljes

OTHERS PRESENT: Mark Anderson; Matt Michels, Senior Planner with Planning & Development Dept.; Brooke Ludwig, WDNR Forester; Jed Kaurich, WDNR Fire Ranger

STAFF PRESENT: Jody Gindt, Josh Pedersen and Bobbi Barone

The meeting was called to order by Chair Patrick LaVelle at 5:00 p.m.

1. Confirmation of meeting notice – Meeting notice was confirmed.
2. Approval of minutes from February 23, 2016 meeting – Paul made a motion to approve the minutes as distributed for February 23, 2016 Committee Meeting; motion carried 4-0.
3. Public Input – No members of the public were present for this item.
4. Pinter Pines/Coon Gut Property Future Plan – As Kevin as not present at the meeting, discussion on this item was postponed to a future meeting.
5. Request to place a memorial bench – Mark Anderson was present for this item and explained that the bench he and his wife wish to place at Lowes Creek Park was to honor his sister-in-law who died at the age of 22. The family hikes regularly at the park. The placement would be on the east side of the park just off the intersection of split rock, red flint, and the pines trails. Bruce made a motion to approve placement of the bench; motion carried 4-0.
7. Presentation/approval of Emergency Fire Wardens for 2016 by Jed Kaurich, WDNR Fire Ranger – Jed passed around the listing of fire wardens to be approved by the committee. Gary made a motion to approve the fire wardens as presented; motion carried. Jed also discussed the fire tower issue and the rational for removing them.
6. Approve 2016-2020 County Outdoor Recreation Plan/resolution 15-16/137 – Matt Michels was present for this item. Josh explained the need for the plan to be eligible for grant funding if listed in plan. He further explained that kayaking and canoeing the Eau Claire River and Equestrian opportunities were focused on which the survey had indicated a need for expanding. Gary suggested something about shooting be included for the county forest and also trash dumping as he felt that was lacking. Matt will work on adding that to the plan. Paul made a motion to approve the recreation plan with the addition of the items Gary suggested; motion carried 4-0.

8. Resolution 15-16/144 offering free camping night May 19, 2016 – After some discussion, Bruce made a motion to change the resolution offering free camping to a camping weekend, not single night, and the weekend to be May 13 and 14, 2016. Motion carried 4-0. More clarification was needed on what fees would be waived and the committee agreed electricity fees should be borne by the camper.
9. Correspondence – Josh read an email from Amber Borton requesting donation of an annual vehicle sticker for a drawing at Northstar Middle School for the PTO sponsored “Family Fun Run”. The committee consensus was to donate. CORBA will be meeting with Josh about rerouting “Onion”. A neighbor of the Guettinger Woods & Wildlife called and complained about dogs off-leash. Josh will have permanent signs made and posted at Guettinger.
10. Staff and committee reports – Jody stated the spring Timber Sale bid opening will be April 12 and the committee will have the sale maps to approve at the next meeting. Josh reported dam workers moving onto the Dam Site yesterday and had begun demoing two of the piers. The early spring-like weather has staff concerned about the project and that the contractors will need to stay on track of repairs in order to complete the job by the March 31 deadline. Pat requested a dam report from Josh for the next county board meeting. Bruce read a letter from Tim Sullivan with Tim’s opinion that management of the Fitz Property would not be legal. Pat suggested Doug Burrows be requested to give a recommendation from the Fitz Working Committee at the next meeting. Josh will contact Doug and try to confirm his appearance.
11. Advisory Committee input and assignments: The Advisory Committee didn’t have a quorum at their March 2 scheduled meeting but had an informal discussion of the forest camping policy and the “pay to play” option for disc golf. The Parks & Forest committee requested the county forest camping policy be on an agenda in the near future.
12. Exposition Center Advisory Committee Input/Assignments – Nothing to report.
13. Committee Education – Time did not allow.
14. Future and pending items: Next meeting date March 22, 2016, 5:00 p.m. at the Ag Center.

Paul made a motion to adjourn and the meeting adjourned at 6:25 p.m.

Respectfully Submitted,

Bobbi Barone
Committee Clerk

EAU CLAIRE COUNTY TIMBER SALE

TRACT 16-15

Sec. 24 T27N R5W

Town of WILSON

SFI® NSF-SFIS-1Y943

FSC® SCS-FM/COC-0083G-E FSC-100%

White Pine Sawlogs	190 MBF
Black/White Oak Sawlogs	5 MBF
White Pine Pulp	685 tons
Aspen Pulp	210 tons
Mixed Hardwood Pulp*	55 tons
Red Pine Pulp	40 tons
Oak Pulp	40 tons

* Mixed Hardwood pulp includes red maple, white birch, & ash.

MINIMUM BID \$30,513.70

Sale Area: 27 acres. Boundary is red paint line, plantation boundaries, and roads.

Cutting Requirements:

Pine Thinning: Cut all trees marked with orange paint.

Pine Final Harvest: Cut all trees EXCEPT scattered oak over 15" DBH.

Final Harvest: Aspen & Mix hardwood. Cut all stems greater than 1" DBH.

Management Objectives: Regenerate oak.

*****FROZEN OR DRY CONDITIONS ONLY*****

*****NO EQUIPMENT OUTSIDE OF RED LINE*****

*****SPECIES OF CONCERN RESTRICTIONS: NO HARVEST MARCH 15 – OCT 15*****

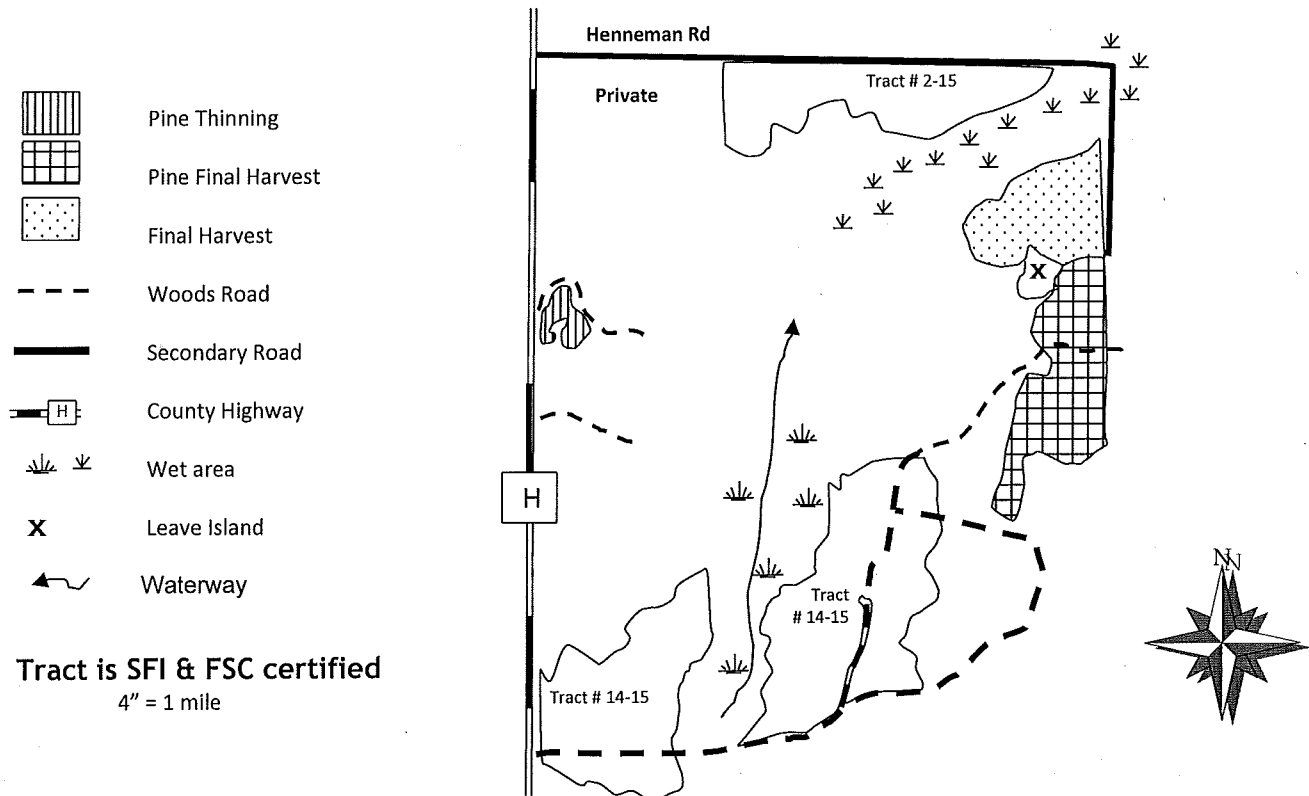

EAU CLAIRE COUNTY TIMBER SALE

TRACT 17-15

Sec. 14, 15, 22 & 23 T27N R6W

Town of LUDINGTON & WILSON

SCS-FM/COC-0083G-E

FSC® SCS-FM/COC-0083G-E FSC-100%

Oak Saw	64 MBF
Mixed Hardwood Saw	8 MBF
Oak Pulp	250 Tons
Mixed Hardwood Pulp	210 Tons
Jack Pine Pulp	200 Tons
MINIMUM BID \$19,663.00	

Sale Area: 38 acres. Sale boundary is red line and blue line. RMZ buffers along wetlands

Cutting Requirements (all units): Cut all trees greater than 1" DBH EXCEPT green marked leave islands.

Management Objectives: Regenerate oak, aspen, and jack pine.

*****OAK WILT RESTRICTIONS APPLY: APRIL 1 – JULY 15*****

*****DRY OR FROZEN CONDITIONS ONLY*****

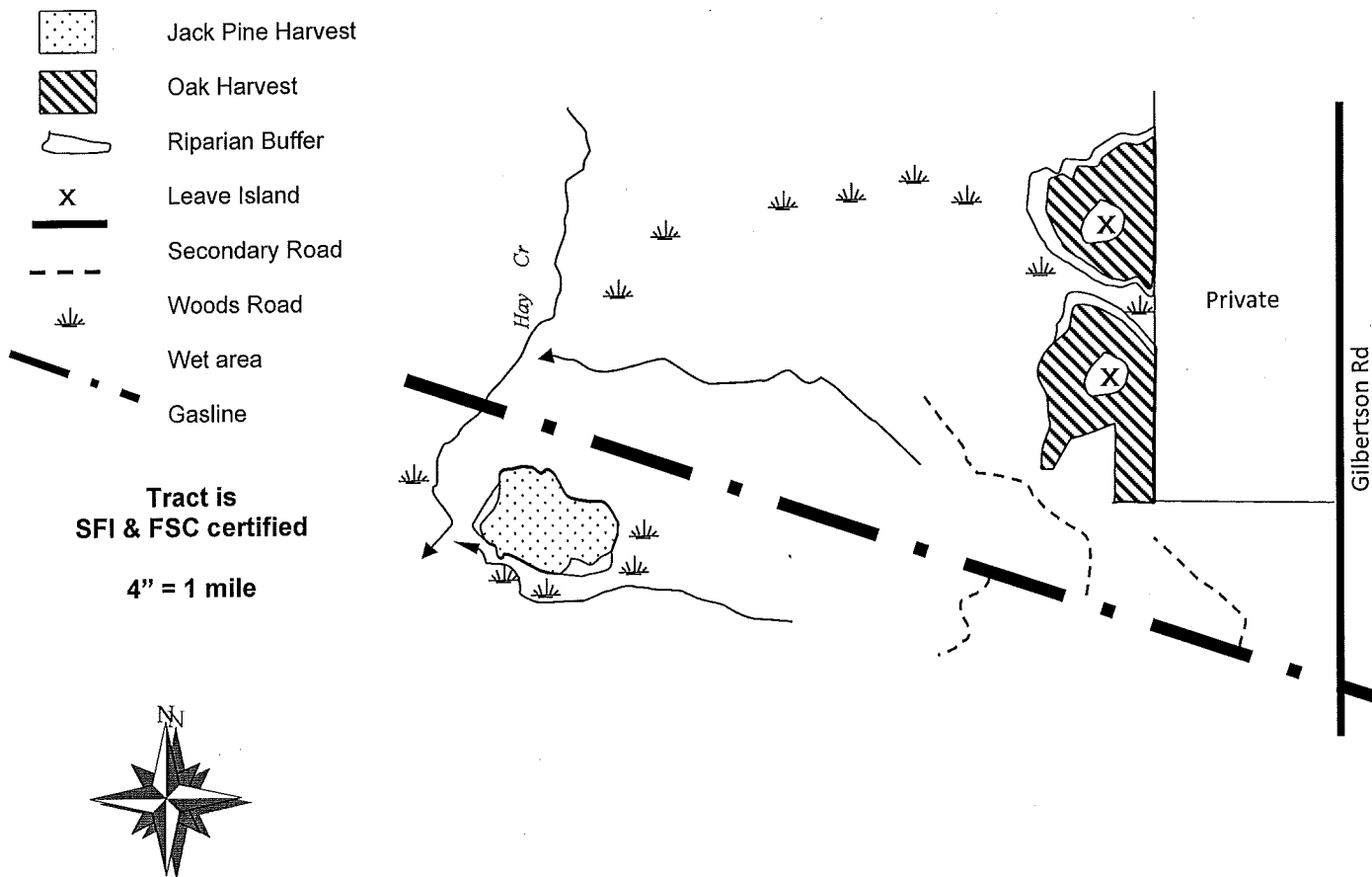

EAU CLAIRE COUNTY TIMBER SALE

TRACT 18-15

Sec.30 T26N R5W

Town of BRIDGECREEK

SFI® NSF-SFIS-1Y943

FSC® SCS-FM/COC-0083G-e FSC-100%

Pine Saw	200 MBF
Oak Saw	135 MBF
Mixed hardwoods Saw	23 MBF
Mixed hardwood Pulp*	1870 tons
White Pine Pulp	875 tons
Oak Pulp	850 tons

*Mixed Hardwood Pulp: 85% maple 10% birch, 5% aspen.

MINIMUM BID \$87,574.50

Sale Area: 74 acres. Sale boundary is red line and trails.

Cutting Requirements: Harvest all trees over 1"DBH. Stay out of green marked leave islands.

Management Objectives: Final harvest of oak and hardwoods to regenerate stand.

*****FIRM (FROZEN OR DRY) GROUND CONDITIONS ONLY*****

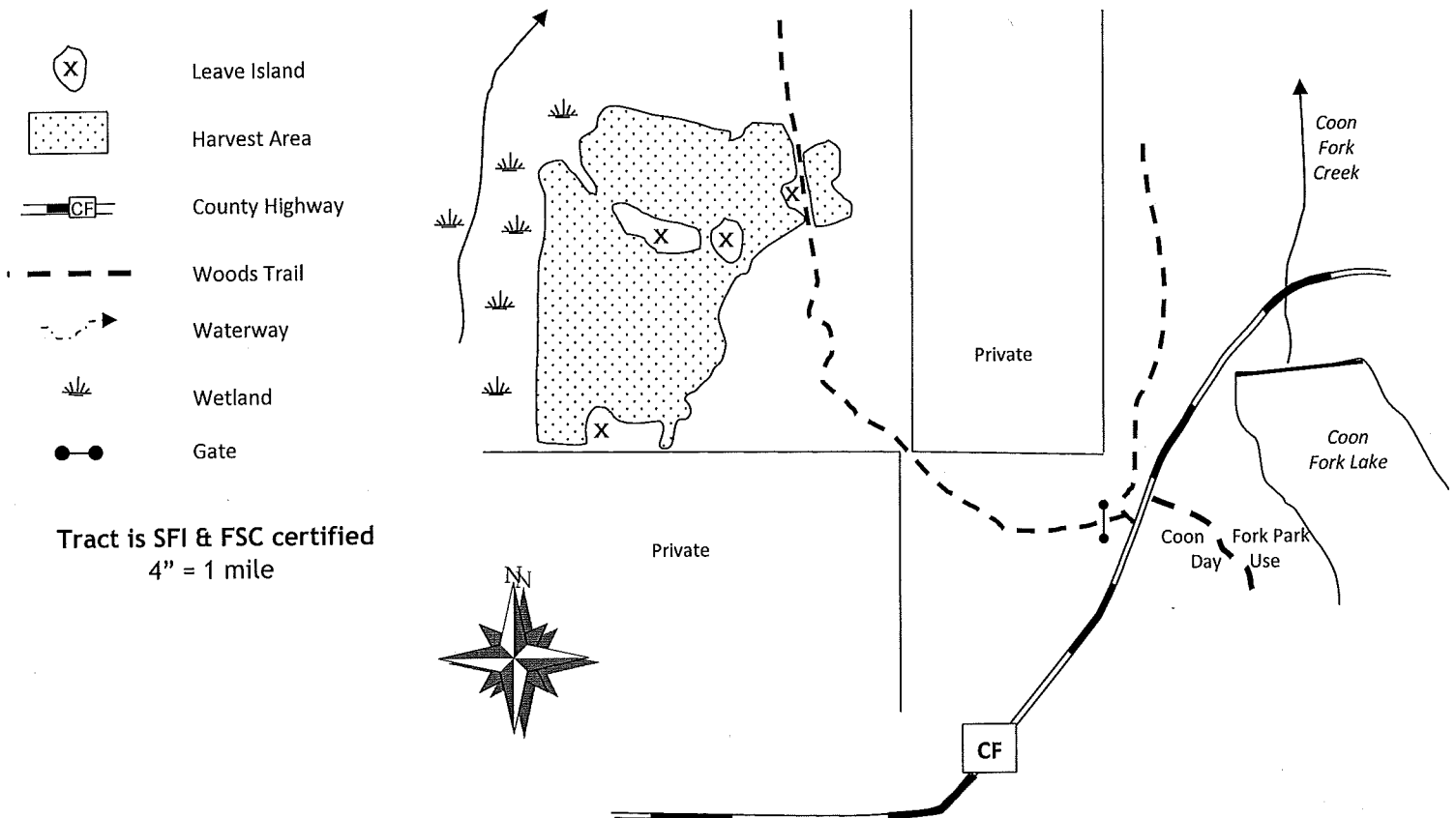

Tract is SFI & FSC certified
4" = 1 mile

EAU CLAIRE COUNTY TIMBER SALE

TRACT 19-15

Sec. 5 T26N R5W

Town of BRIDGE CREEK

SCS-FM/COC-0083G-E

FSC® SCS-FM/COC-0083G-E FSC-100%

Oak Saw Logs (Black and Red)	137 MBF	
Mix Saw Logs (65% white oak, 35% maple)	80 MBF	
Red Pine Pulp (Comingled, 65% saw)	1390 tons	
Oak Pulp	860 tons	
Mix Hardwood Pulp (80% maple, 20% birch & cherry)	640 tons	
White Pine Pulp (Comingled, 30% saw)	230 tons	
Aspen Pulp	140 tons	
		MINIMUM BID \$ 109,639.00

Sale Area: 68 acres. Boundary is red paint, plantation boundary, and ATV trail. Green paint marks leave islands.

Cutting Requirements:

Pine Final Harvest: Cut all pine & hardwood. Minimize damage to advanced regeneration.

Shelterwood: Cut all trees greater than 1" dbh EXCEPT DO NOT cut green marked trees.

Oak & Hwds Harvest: Cut all trees greater than 1" dbh EXCEPT DO NOT cut green marked trees.

Pine Thinning: Cut all orange marked white and red pine. Small area of fire scarred pine will be clearcut.

Management Objectives: Regenerate oak, hardwoods & release regeneration in red pine final harvest.

*****OAK WILT RESTRICTIONS APPLY APRIL 1 TO JULY 15*****

*****ANNOSUM/HETEROBOSIDIUM STUMP TREATMENT EXCEPT RED PINE FINAL HARVEST *****

*****AREAS OF HARVEST MAY BE SOFT, NO RUTTING ALLOWED*****

*****ACCESS ACROSS PRIVATE NOT NEGOTIATED BY COUNTY*****

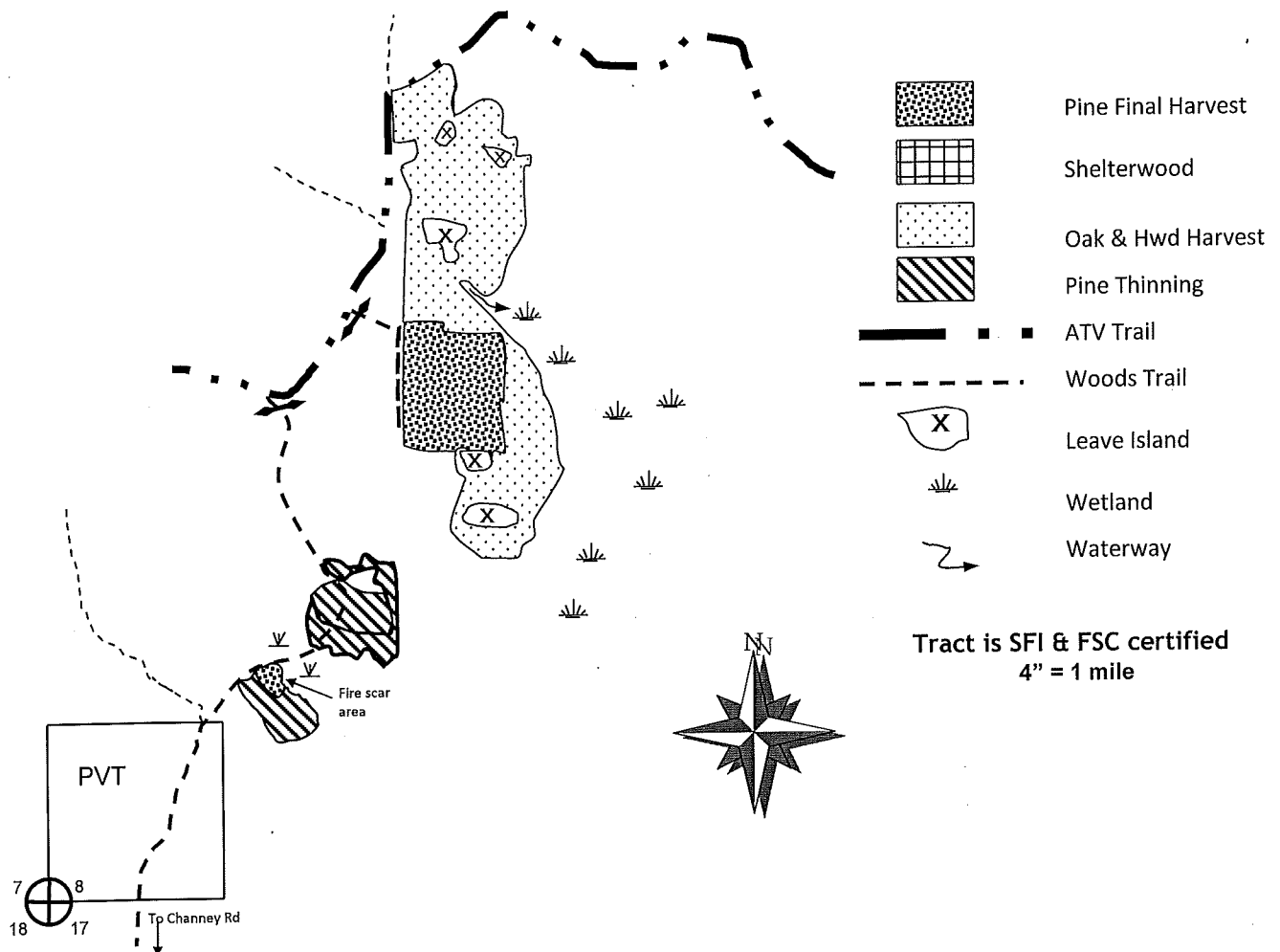

Tract is SFI & FSC certified
4" = 1 mile

EAU CLAIRE COUNTY TIMBER SALE

TRACT 20-15

Sec. 23, 24, & 25 T25N R5W

Town of FAIRCHILD

SFI® NSF-SFIS-1Y943

FSC® SCS-FM/COC-0083G-E FSC PURE

Red Pine (Comingled)	1,980 tons
Aspen	750 tons
White Pine	30 tons
Mixed Hardwood	300 tons
White Pine Saw	16 MBF
Mixed Hardwood Saw	8 MBF

MINIMUM BID \$57,139.00

Sale Area: 108 acres. Sale boundary is red line, plantation edges, road, and trails.

Cutting Requirements:

Red Pine Thinning/White Pine Thinning: Cut all trees marked with orange

Aspen Harvest: Harvest all trees over 1" DBH including pine.

Management Objectives: Thin pine to improve vigor and harvest aspen to regenerate stand.

*****FIRM (FROZEN OR DRY) GROUND CONDITIONS ONLY*****

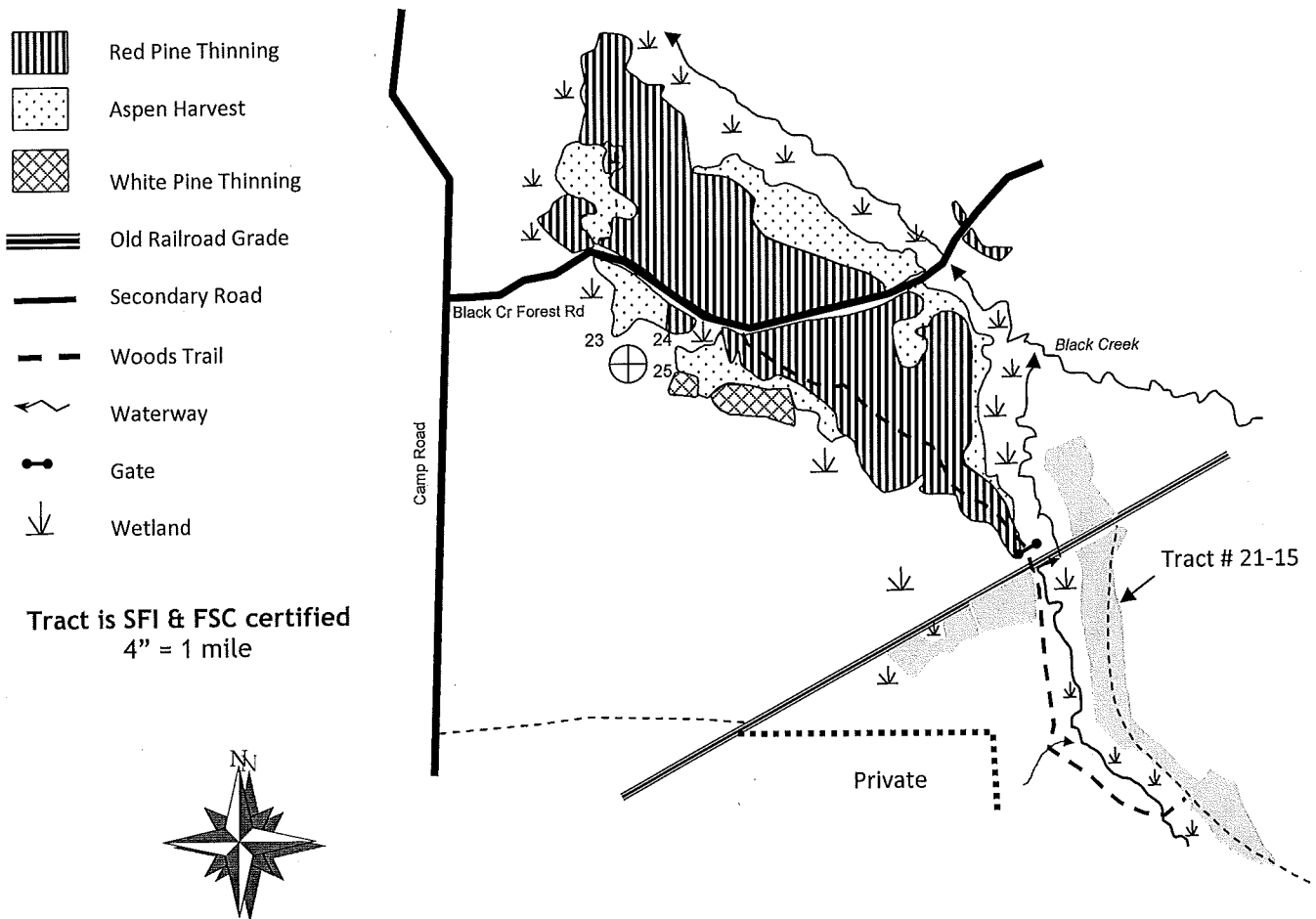

EAU CLAIRE COUNTY TIMBER SALE

TRACT 21-15

Sec. 25 T25N R5W

Town of FAIRCHILD

SFI® NSF-SFIS-1Y943

FSC® SCS-FM/COC-0083G-E FSC PURE

Red Pine* (Comingled)	690 tons
White Pine** (Comingled)	115 tons
Aspen pulp	10 tons

*Red Pine 30% saw

**White Pine 70% saw

MINIMUM BID \$22,432.50

Sale Area: 26 acres. Sale boundary is red line, plantation edges, and trails.

Cutting Requirements:

Red Pine Thinning: Cut all trees marked with orange

White Pine Harvest: Harvest all trees over 2" DBH

Management Objectives: Thin red pine to improve vigor; harvest white pine overstory to release regeneration.

*****FIRM (FROZEN OR DRY) GROUND CONDITIONS ONLY*****

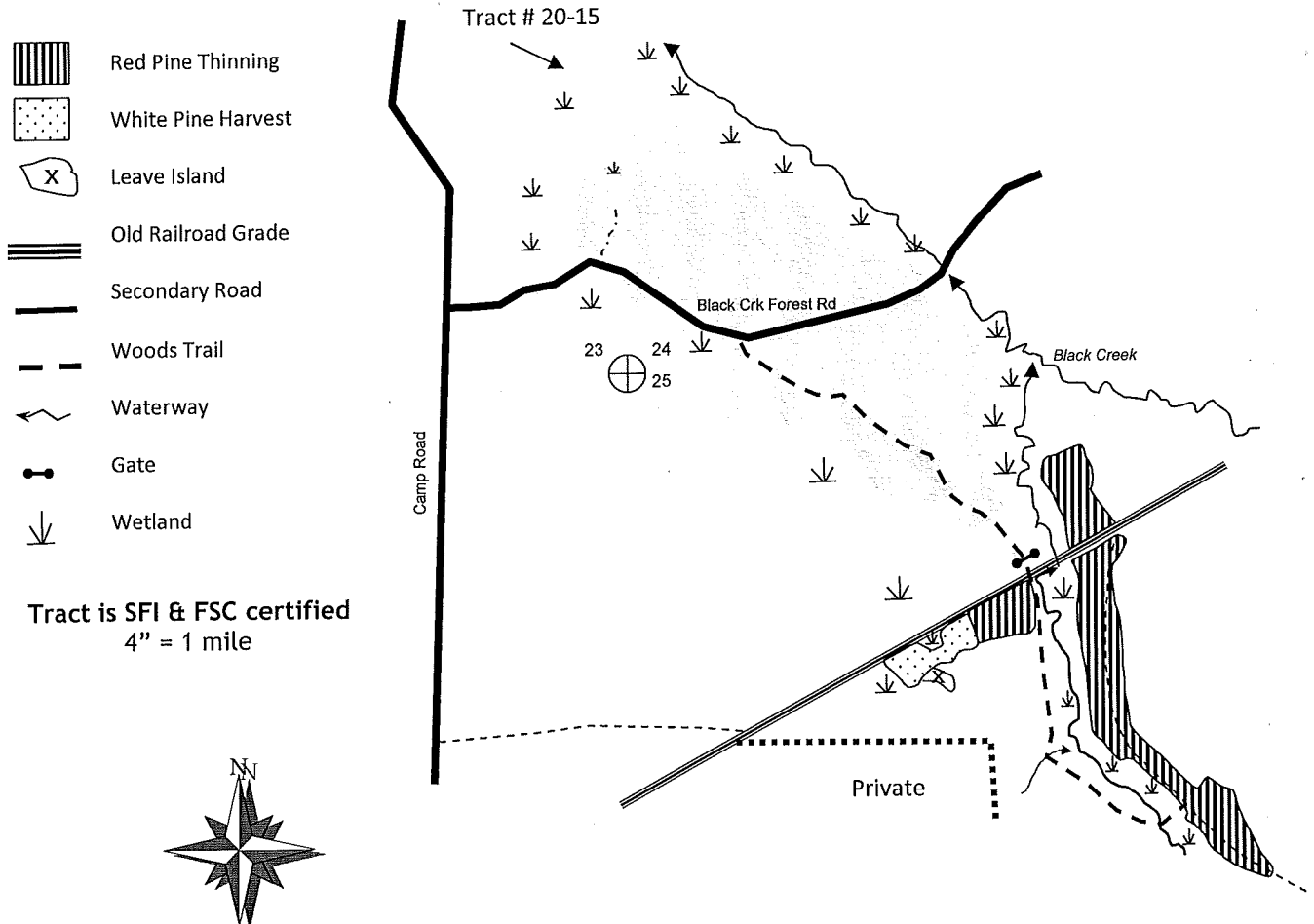

**EAU CLAIRE COUNTY TIMBER SALE
TRACT 22-15
Sec. 24 T26N R5W
Town of BRIDGE CREEK
SFI® NSF-SFIS-1Y943
FSC® SCS-FM/COC-0083G-E FSC 100%**

Mix Logs (60% oak, 35% basswood, 10% red maple, 5% ash)	73 MBF
White Pine Logs	10 MBF
Jack Pine Pulp (<5% white pine)	1270 Tons
Oak Pulp	1000 Tons
Red Pine (comingled 40% saw)	470 Tons
Basswood Pulp	200 Tons
Aspen Pulp	160 Tons
Red Maple Pulp (<5% ash)	130 Tons
MINIMUM BID	\$52,710.00

Sale Area: 97 acres. Boundary is red line and blue line. RMZ's (River Corridor) are marked in red line.

Cutting Requirements: Cut all trees EXCEPT any marked with red, blue, or green paint.

Management Objectives: Jack Pine regeneration.

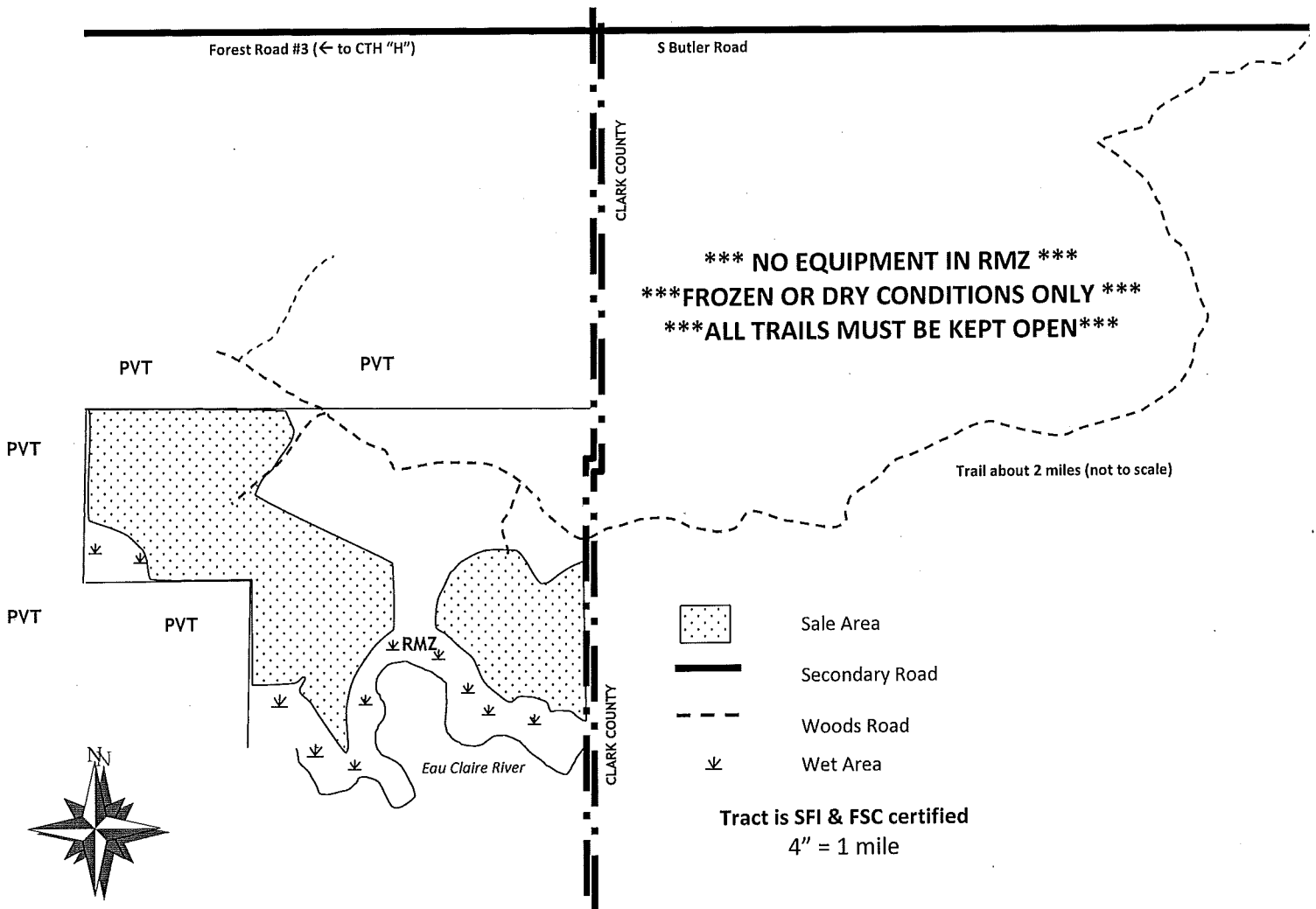

EAU CLAIRE COUNTY TIMBER SALE

TRACT 2-16

Sec.1 & 12 T26N R5W
Town of BRIDGECREEK
SFI® NSF-SFIS-1Y943

FSC® SCS-FM/COC-0083G-e FSC-100%

Aspen Pulp	350 tons
Mixed hardwood Pulp*	320 tons
Red Pine Pulp	20 tons
Oak Logs**	10 MBF

MINIMUM BID \$8,346.00

*Mixed hardwood pulp is 70% red maple, 15% birch, and 15% oak.
**Oak logs 20% red maple

Sale Area: 17 acres. Sale boundary is red line and trails.

Cutting Requirements: Harvest all trees over 1"DBH including pine pocket in the north east corner.

Management Objectives: Final harvest of small red pine area and regenerate aspen and hardwoods.

*****FIRM (FROZEN OR DRY) GROUND CONDITIONS ONLY*****

*****ANNOSUM/HETEROBASIDION SPRAYING PER CONTRACT REQUIREMENTS*****

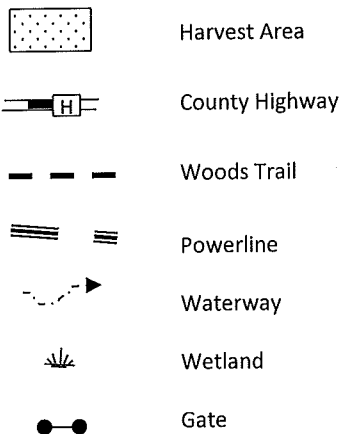

Tract is SFI & FSC certified
4" = 1 mile

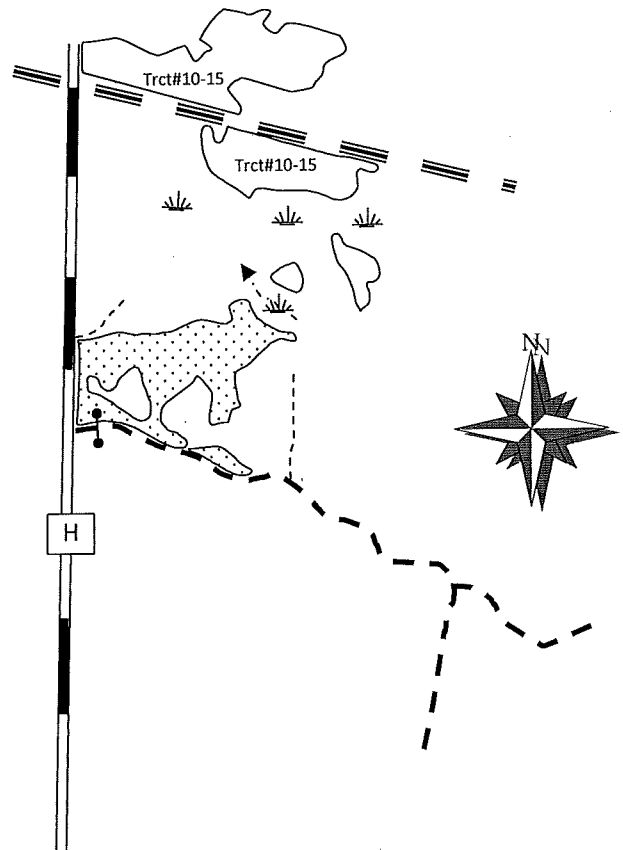

EAU CLAIRE COUNTY FOREST

2016 SPRING TIMBER SALES

TRACT #	Tons	MBF	Clearcut Acres	Selective Acres	Total Acres	Appraised Value	Advertised Value	ACRES BY SPECIES							TOTAL	T	R	SEC	TWNShp
								A	MR	O	PJ	PR	PW						
16-15	1,030	195	31	2	33	\$30,513.70	\$30,513.70	9	4				2	18	33	27	5	24	Wilson
17-15	660	72	47	0	47	\$19,629.00	\$19,663.00			35	12				47	27	6	15	Wilson
18-15	3,595	358	85	0	85	\$87,574.50	\$87,574.50			85					85	26	5	30	Brg Crk
19-15	3,260	217	55	17	72	\$109,636.89	\$109,625.00			46			21	5	72	26	5	8	Brg Crk
20-15	3,060	24	34	82	116	\$57,139.00	\$57,139.00	34					79	3	116	25	5	24	Fairchild
21-15	815	0	5	23	28	\$22,408.35	\$22,432.50						23	5	28	25	5	25	Fairchild
22-15	3,230	83	97	0	97	\$52,652.70	\$52,710.00		45	52					97	26	5	24	Brg Crk
2-16	690	10	19	0	19	\$8,367.85	\$8,346.00	19							19	26	5	12	Brg Crk
TOTAL	16,340	959	373	124	497	\$387,921.99	\$388,003.70	62	49	218	12	125	31	497					
% OF TOTAL SALES			75.05%	24.95%			100.02%	12.5%	9.9%	43.9%	2.4%	25.2%	6.2%	100.0%					

SUMMARY	
Total Ac	497
Total Tons	16,340
Total MBF	959.0
# of sales	8

Tons	
Aspen	1,620
Mx Hwd	3,725
Oak	3,000
J Pine	1,470
Red Pine	4,590
Wht Pine	1,935
Total Tons	16,340
MBF	
Mx Hwd	192
Oak	351
Wht Pine	416
Total MBF	959

TRACT #	Tons	MBF	Tons						MBF			
			A	MX	O	PR	PJ	PW	O	MX	PW	
16-15	1030	195.0	210	55	40	40			685	5		190
17-15	660	72.0		210	250			200		64	8	
18-15	3595	358.0		1870	850				875	135	23	200
19-15	3260	217.0	140	640	860	1390			230	137	80	
20-15	3060	24.0	750	300		1980			30		8	16
21-15	815	0.0	10			690			115			
22-15	3230	83.0	160	330	1000	470	1270				73	10
2-16	690	10.0	350	320		20				10		
TOTAL	16340	959	1620	3725	3000	4590	1470	1935	351	192	416	
% OF TOTAL Tons/ MBF			9.9%	22.8%	18.4%	28.1%	9.0%	11.8%	36.6%	20.0%	43.4%	
Cord Eqv			720	1637	1091	2040	692	921	772	422	1015	